

# SHR-5040/5080/5160 SHR-5042/5082/5162

4/8/16 Channel Standalone Digital Video Recorders

## SHR-5042

- Compression : MPEG4(Video) / G.726(Audio)
- REC Speed : CIF 120/100 (N/P)
- Internal HDD (HDDx1)
- \*SHR-5040 : Max 2 internal HDD (HDDx2)



## SHR-5082

- Compression : MPEG4(Video) / ADPCM(Audio)
- REC Speed : CIF 120/100 (N/P)
- MAX 3 Internal HDD (HDDx3)
- \*SHR-5080 : Max 4 internal HDD (HDDx4)



## SHR-5162

- Compression : MPEG4(Video) / ADPCM(Audio)
- REC Speed : CIF 120/100 (N/P)
- MAX 3 Internal HDD (HDDx3)
- \*SHR-5160 : Max 4 internal HDD (HDDx4)



## Features

- Video recording up to 120/100ips and 4 channel audio recording
- Recording and network transmission via each codec by adopting dual codec.
- Exclusive video processor: image quality improved by more than 30% compared to existing products.
- Various backup functions through USB 2.0 : USB memory, external HDD, external CD-RW (SHR-5042), DVD-RW (SHR-5082/5162).
- Various video outputs supported.
- Simultaneous VGA and composite output.
- Watermark function for preventing video alteration.
- Remote monitoring and control through network: Ethernet, cable network, xDSL.
- Convenient IR remote controller and mouse (SHR-504x: only remote controller available).
- Smooth backup by using built-in DVD-RW (SHR-5082/5162).
- Convenient user interface

## Dimensions (unit:mm)

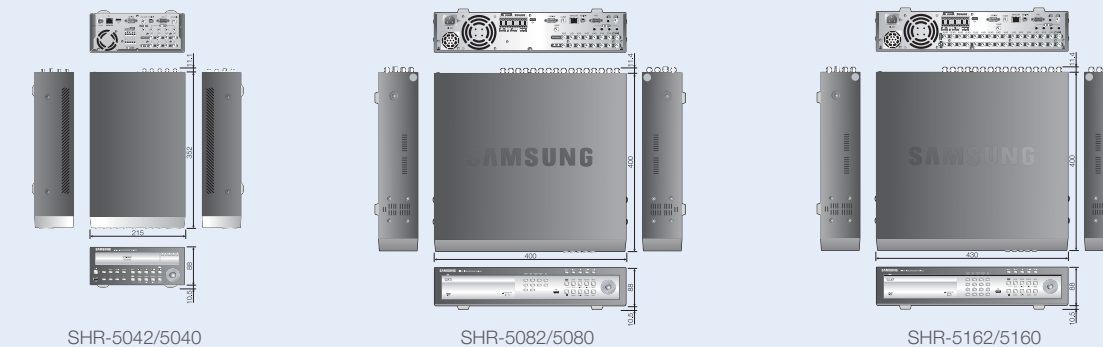

SHR-5042/5040

SHR-5082/5080

SHR-5162/5160

# SHR-5040/5080/5160 SHR-5042/5082/5162

4/8/16 Channel Standalone Digital Video Recorders

## Specifications

| Model                                 | SHR-5040/5042                           |  | SHR-5080/5082  | SHR-5160/5162                                      |                            |
|---------------------------------------|---|--|--|--|----------------------------|
| Video                                 | Input                                   | Composite  | 4 Channels, 1Vp-p, 75 Ohm  | 8 Channels, 1Vp-p, 75 Ohm                          | 16 Channels, 1Vp-p, 75 Ohm |
|                                       | Output                                  | Composite  | 2 channels (Normal 1 Channel, Spot 1 Channel)  | 3 Channels (Normal 1 Channel, Spot 2 Channels)     |                            |
|                                       |   | S-Video  | 1 Channel  | 1 Channel  |                            |
|                                       |   | VGA  | 1 Channel  | 1 Channel  |                            |
|                                       | Loop Through                            | 4 Channels   | 8 Channels   | 16 Channels  |                            |
| Audio                                 | Input / Output                          | Mono 4 Channels, RCA / 1 Channel, RCA  |  | Mono 4 Channels, RCA / 1 Channel, RCA              |                            |
| Live Screen                           | Resolution                              | D1   | D1   | D1   |                            |
|                                       | Display Speed(NTSC/PAL)                 | 120ips / 100ips  | 240ips / 200ips  | 480ips / 400ips                                    |                            |
| Recording                             | Display Mode                            | Single, 4, PIP, Sequence, Freeze, 2x Zoom  | Single, 4, 6, 7, 8, 9, 16, PIP, Sequence, Freeze, 2x Zoom  | Single, 4, 6, 7, 9, PIP, Sequence, Freeze, 2x Zoom |                            |
|                                       | Compression Method                      | Video/Audio  | MPEG4/ADPCM  | MPEG4/ADPCM  |                            |
| Video Compression Rate (Kbyte/image)  | Level 8                                 | Very High : 45.1(D1), 24.0(Half D1), 14.2(CIF)   | NTSC : 8.8(Half D1), 5.1(CIF) / PAL : 10.5(Half D1), 6.1(CIF)  |  |                            |
|                                       | Level 7                                 | High : 29.5(D1), 15.9(Half D1), 9.5(CIF)   | NTSC : 7.8(Half D1), 4.5(CIF) / PAL : 9.4(Half D1), 5.5(CIF)   |  |                            |
|                                       | Level 6                                 | Standard : 17.4(D1), 8.5(Half D1), 4.9(CIF)  | NTSC : 6.8(Half D1), 4.0(CIF) / PAL : 8.3(Half D1), 4.8(CIF)   |  |                            |
|                                       | Level 5                                 | Low : 9.1(D1), 4.7(Half D1), 2.8(CIF)  | NTSC : 6.0(Half D1), 3.4(CIF) / PAL : 7.1(Half D1), 4.2(CIF)   |  |                            |
|                                       | Level 4                                 | -  | NTSC : 5.0(Half D1), 2.9(CIF) / PAL : 6.0(Half D1), 3.4(CIF)   |  |                            |
|                                       | Level 3                                 | -  | NTSC : 4.0(Half D1), 2.3(CIF) / PAL : 4.9(Half D1), 2.8(CIF)   |  |                            |
|                                       | Level 2                                 | -  | NTSC : 3.1(Half D1), 1.8(CIF) / PAL : 3.7(Half D1), 2.0(CIF)   |  |                            |
|                                       | Level 1                                 | -  | NTSC : 2.2(Half D1), 1.2(CIF) / PAL : 2.6(Half D1), 1.5(CIF)   |  |                            |
| Resolution                            |   | CIF, Half D1, Full D1  | CIF, Half D1   |  |                            |
|                                       | Max. Recording Speed(NTSC/PAL)          | CIF:120/100ips, Half D1:60/50ips, Full D1:30/25ips   | CIF:120/100ips, Half D1:60/50ips   |  |                            |
| Recording Mode                        |   | Events (Alarm, Motion Detection, Video Loss), Schedule Recording, Time Lapse   |  |  |                            |
|                                       | Compression Method                      | Video/Audio  | MPEG4/ADPCM  |  |                            |
| Network Transmission                  | Video Compression Rate (Kbyte/image)    | Very High  | NTSC : 9.8(Half D1), 4.9(CIF) / PAL : 11.7(Half D1), 5.9(CIF)  |  |                            |
|                                       |   | High   | NTSC : 7.3(Half D1), 3.7(CIF) / PAL : 8.8(Half D1), 4.4(CIF)   |  |                            |
|                                       |   | Standard   | NTSC : 4.9(Half D1), 2.4(CIF) / PAL : 5.9(Half D1), 2.9(CIF)   |  |                            |
|                                       | Low                                     | NTSC : 2.4(Half D1), 1.2(CIF) / PAL : 2.9(Half D1), 1.5(CIF)   |  |  |                            |
| Resolution                            |   | CIF, Half D1, Full D1  | CIF, Half D1   |  |                            |
|                                       | Search Mode                             | Date/Time Search, Search by Camera, Event Search (Alarm, Motion Detection, Video Loss), First/ Latest/ Backup Search             | Calendar Search, Event Search (Alarm, Motion Detection, Video Loss), First / Latest / Backup Search  |  |                            |
| Display Mode                          |   | Single, 4, 9 (4 Play Screens, 4 Live Screens)  | Single, 4, 9, 16, PIP (1 Channel for Play, 1 Channel for Live), Triplex 9 (1 Channel for Play, 8 Channels for Live), Triplex 16 (1 Channel for Play, 15 Channels for Live) |  |                            |
|                                       | Play Mode                               | Play, Pause, Stop  | Play, Pause, Stop, 2x Digital Zoom, Fast Forward/Fast Reverse(x2, x4, x8, x16, x32, x64)   |  |                            |
| Event                                 | Alarm Function/Alarm Input/Alarm Output | Remote Callback / 4 Channels / 2 Channels  | Remote Callback / 8 Channels / 4 Channels  | Remote Callback / 16 Channels / 4 Channels         |                            |
|                                       | Alarm Output Continuation Time          | Alarm continues until it is turned off   | Off, 3, 5, 10, 20, 30  |  |                            |
|                                       | Motion Detection                        | Area Setup (5 steps)   | Area Setup   |  |                            |
|                                       | Pre Event Set Time                      | 3, 4, 5 sec  | Off, 5, 10, 20, 30 sec   |  |                            |
| Post Event Set Time                   | 5, 10, 20, 30 sec, 1, 3, 5 Min          | Off, 5, 10, 20, 30 sec, 1, 3, 5, 10, 20 Min  |  |  |                            |
| Water Mark                            |   | Yes  | Yes  |  |                            |
|                                       | HDD                                     | Default : 250G (SHR-5040:160G)<br>Extension : 250G / 250Gx2  | 250G / 250G  | 250Gx3 / 250Gx4                                    |                            |
| CD-RW / DVD-RW                        |   | CD-RW(SHR-5042) / -(SHR-5040)  | DVD-RW(SHR-5082) / -(SHR-5080)   | DVD-RW(SHR-5162) / -(SHR-5160)                     |                            |
|                                       | Backup                                  | Interface : USB 2.0 2 Ports (1 at the front, 1 at the rear)<br>Media : CD-RW, External HDD, USB Memory<br>File Format : SFX, AVI | CD-RW, DVD-RW, External HDD, USB Memory<br>AVI   |  |                            |
| External Port                         | RS-485                                  | PTZ Control  | PTZ Control, System Keyboard   |  |                            |
|                                       | USB Mouse / Remote Controller / Network | Yes / Yes / Static IP, DHCP, ADSL (PPPoE)  | - / Yes / Static IP, DHCP, ADSL (PPPoE)  |  |                            |
| Operating Temp. / Operating Humidity  | 0°C ~ 40°C / 25% ~ 80% RH               | 0°C ~ 40°C / 20% ~ 80% RH  |  |  |                            |
| Power Requirement / Power Consumption | AC 100~240V, 50/60Hz / 28W              | AC 100~230V, 50/60Hz / 60W   |  |  |                            |
| Weight / Outline Dimension            | 4.0Kg / 215(W) x 88(H) x 352(D)mm       | 7.3Kg / 430(W) x 88(H) x 400(D)mm  |  |  |                            |



SHR-5040/5042

SHR-5080/5082

SHR-5160/5162

imagine a DVR that allows separate recording and transmission of field images by using a dual codec system



SAMSUNG ELECTRONICS CO., LTD.

Digital AV Division  
VSS marketing, 415, Maetan 3 Dong, YeongTong-Gu, Suwon City, Kyeonggi-Do, Korea, 443-742  
Tel: +82-31-277-3342-3347 Fax: +82-31-277-6597 http://www.secURITYsamsung.com

Distributed by

\* Design and specifications are subject to change without notice



# Dual Codec SHR-5000 Series



The SHR-5000 Series DVR is a standalone system that can record up to 120/100 images per second from 4, 8 and 16 channels using MPEG4 compression. It is able to simultaneously record to and play from a hard drive in real time by compressing the audio of 4 channels with ADPCM (Adaptive Differential Pulse Code Modulation). Using dual codecs, the SHR-5000 Series DVR can smoothly record and transmit through a network, allowing continuous remote monitoring even in a poor network environment. It provides backup functions through its USB 2.0 interface. In addition, it maximizes user convenience by implementing ATM and POS interlocking, motion detection, various split screens a PIP function as well as various video output functions.

## Dual Codec allows stabilized transmission in a low bandwidth network environment

The SHR-5000 Series DVR uses separate Codecs to record videos and to transmit them via a network. This allows high-definition video to be recorded to a HDD and continuous remote monitoring to occur in a low band network environment.

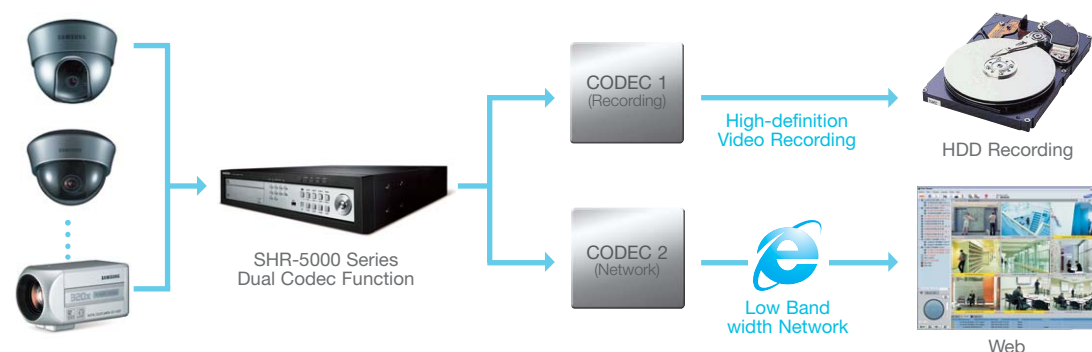

DVRs that enhance the surveillance environment by improving the network transmission of high-definition video

## Maximized Compression Efficiency

The SHR-5000 Series DVRs use less storage space on HDD by approximately 35% by using an innovative integrated circuit design which maximizes video compression.



## Built-in DVD-RW

The SHR-5082/5162 with a built-in DVD-RW can easily back up video recorded by the DVR. (The SHR-5042 used a built-in CD-RW)

\*DVD Backup: 4.0GB / CD Backup: 700MB



## Web based Monitoring & Search

The SHR-5000 Series DVR comes with a built-in web server in the DVR. This allows remote connection to the DVR through a web browser without the need of a separate program, maximizing user convenience.



## Monitoring with Network-Integrated Viewer (NetI)

The SHR-5000 Series DVR can be monitored with NetI, Samsung Electronics, integrated viewing solution, allowing easy set up of a video management network.

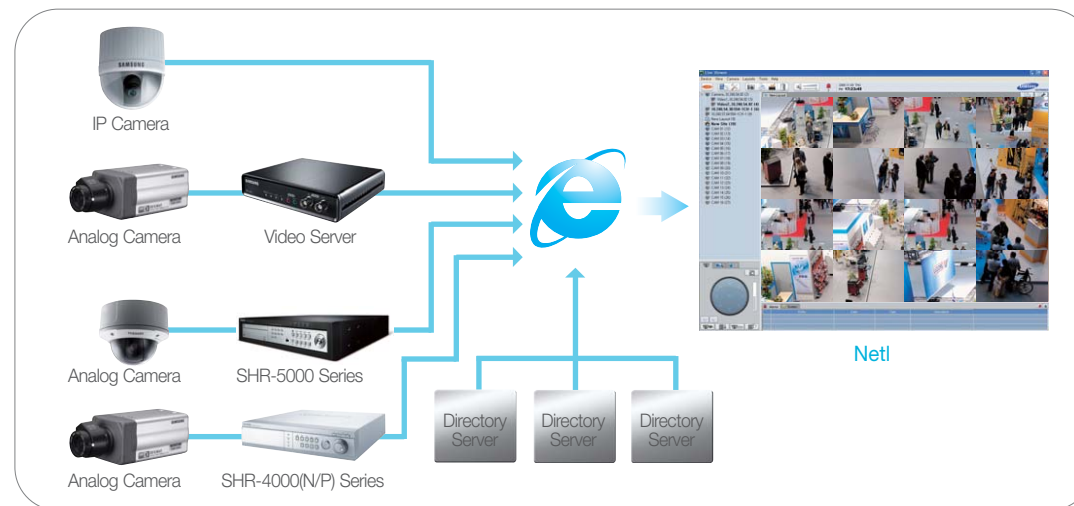

## File Size by Resolution and Compression Rate

| Compression Rate (Average) | Resolution | CIF | Half D1 |
|----------------------------|------------|-----|---------|
|                            | Very High  | 4.9 | 9.8     |
| High                       | 3.7        | 7.3 |         |
| Normal                     | 2.4        | 4.9 |         |
| Low                        | 1.2        | 2.4 |         |

\*The file size may be changed according to the type of the input video signal.

## Simultaneous BNC and VGA Output

For user convenience the SHR-5000 Series DVRs simultaneously output video for both LCD monitors and CRT monitors

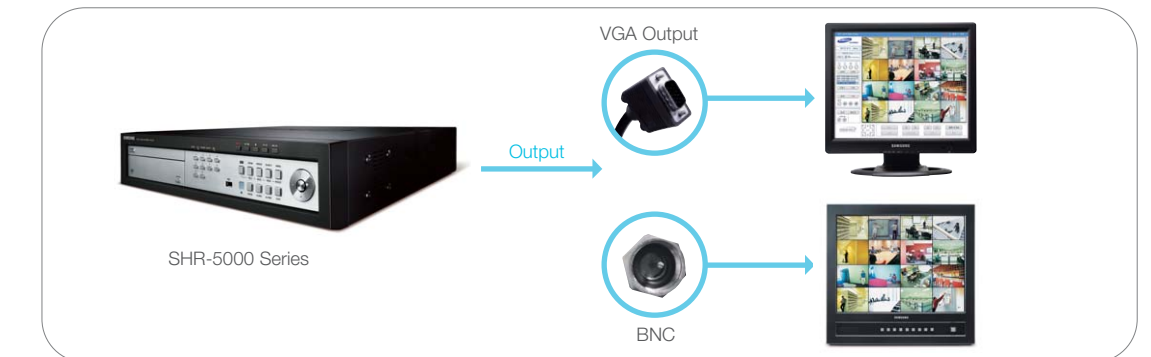

## Provides UI for User Convenience



### MENU SETUP SCREEN

- Monitoring and recording up to 480/400ips and 120/100ips respectively
- Live display of up to 480/400ips and recording of up to 120/100ips



### SEARCH SCREEN

- Search by Calendar and Event
- Search by Time and Date or by Event



### Remote Monitoring Screen

- Remote DVR management function
- Callback function
- Allowing simultaneous connection up to 3 users

